

# INSTALLATION INSTRUCTION

---

## MVVM



Outer ventilation hood  
for one-sided installation

---



## PURPOSE

The outer ventilation hood is designed to prevent ingress of water and foreign objects into the ventilation equipment from outside. Special design allows installation of the hood from the inside enabling safe mounting on a wall of high-rise buildings.



**THE OUTER VENTILATION HOOD MAY NOT BE OPERATED BY CHILDREN OR PERSONS WITH REDUCED PHYSICAL, MENTAL OR SENSORY CAPACITIES, OR LACKING THE APPROPRIATE TRAINING.**

**THE CHOICE OF THE VENTILATION HOOD INSTALLATION LOCATION MUST PREVENT UNAUTHORIZED ACCESS BY UNATTENDED CHILDREN.**

## DELIVERY SET

Name	Number
Outer ventilation hood	1 item
Air duct	1 item
Mounting kit	1 item
Mounting hood installation instruction	1 item
Packing box	1 item

## DESIGNATION KEY

VENTS MVM 162 XX

### Air duct length

\_ - air duct is not included in delivery  
 03 - 300 mm long air duct  
 05 - 500 mm long air duct  
 07 - 700 mm long air duct  
 08 - 800 mm long air duct

### Nominal dimension

162 - 160 mm round air duct

### Model

## OVERALL DIMENSIONS, MM (INCH)

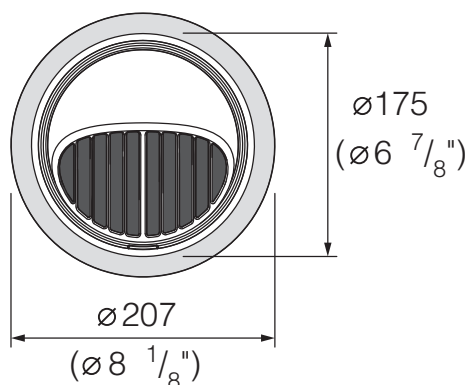
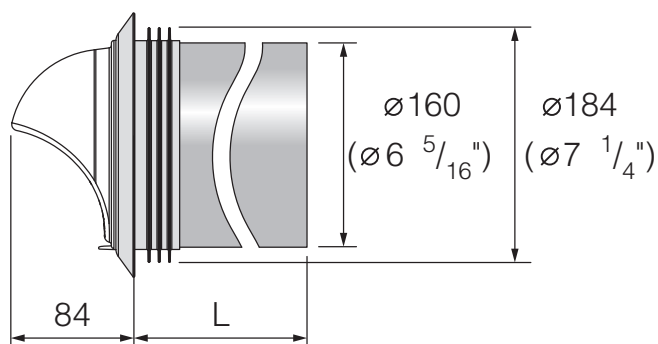

Model	L	
	mm	inch
MVM 162	-	-
MVM 162 03	300	11 13/16"
MVM 162 05	500	19 11/16"
MVM 162 07	700	27 9/16"
MVM 162 08	800	31 1/2"



## OUTER VENTILATION HOOD MOUNTING

1. Drill a 180 mm hole in the wall.  
Apply a true vertical mark through the hole centre for proper ventilation hood alignment.  
Insert a tape measure into the hole to measure the wall thickness.

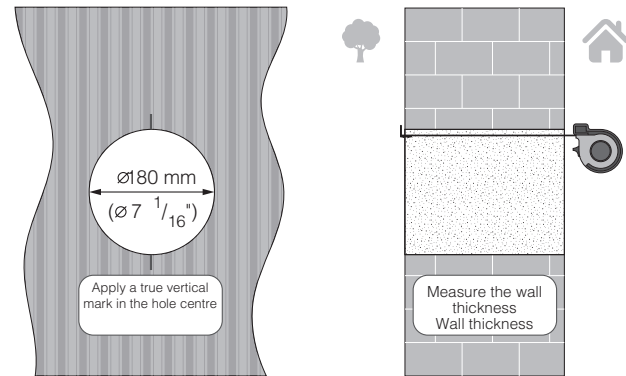

2. Apply a mark to the ventilation hood air duct at the distance equal to the wall thickness obtained earlier.

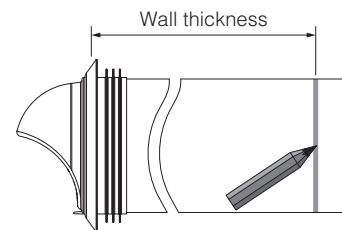

3. Insert the ventilation hood into the hole until the collar protrudes from the outer wall surface.

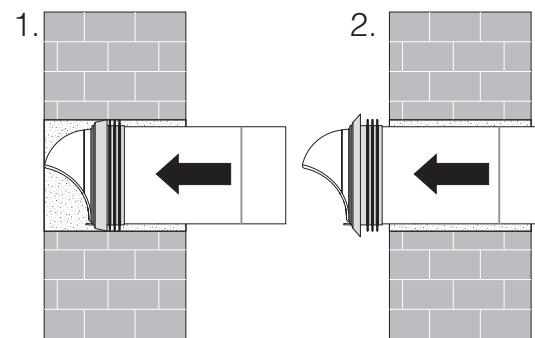

4. Centre the ventilation hood in such a way so that the hood ridge forms a straight line with the marks on the wall.  
Then pull the ventilation hood in the opposite direction until the mark on the air duct reaches the wall level.

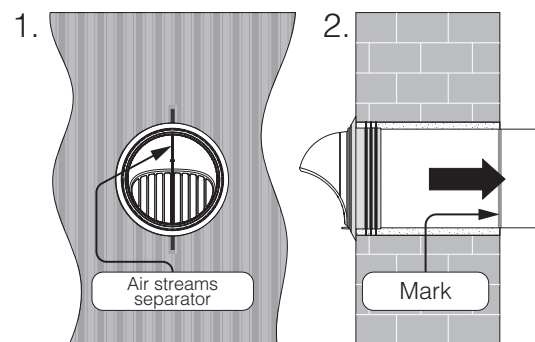

5. To centre the air duct use plastic foam wedges (included in delivery).  
Install the air duct with the minimum slope 3° downwards.  
Fill the gaps with sealing foam to secure the air duct in the wall space.  
Trim the protruding part of the air duct to the required length.

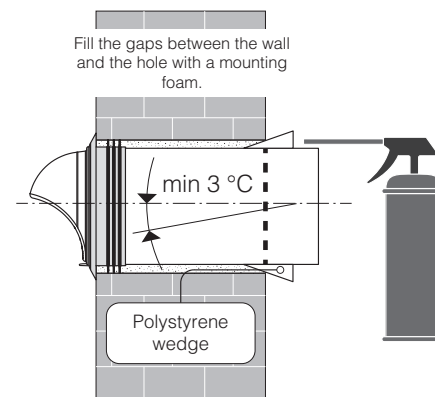



V136EN-01

