

### VENTS CF3 Series



Centrifugal fans for exhaust ventilation with the capacity up to 90 m<sup>3</sup>/h

#### Applications

- Continuous or periodic exhaust ventilation of bathroom, showers, kitchens and other utility spaces.
- Ventilation shaft mounting or duct connection.
- Designed for high-resistance ventilation duct systems.
- Compatible with Ø 100 mm air ducts.

#### Design

- Modern design and aesthetic look.
- The casing and the impeller are made of high-quality durable ABS plastic, UV resistant.
- The easy to use removable grille with a filter element protects the fan internal components against grease and dust penetration and makes it suitable for kitchen exhaust ventilation.
- The basic CF3 fan modification includes a dust filter. Aluminium grease filter configurations are also available (CFA3 model).
- The centrifugal fan impeller has forward-curved blades for high pressure and low noise levels.
- Equipped with a gravitational backdraft damper for air back flow prevention.
- Protection rating IP 24.

#### Motor

- Reliable and low-watt single-phase three-speed electric motor.
- Motor equipped with ball bearings mounted on specially designed vibration dampers.
- Designed for continuous operation and requires no maintenance.
- Equipped with overheating protection.

#### Modifications and Options

- CFA3 – fan with an aluminium grease filter
- CF3 P3 – fan with a three speed switch.

#### Control

- Manual:**
- The fan is controlled by the speed switch P3-1-300 delivered as a standard (CF3 P3 model).

**Automatic:**

    - By the electronic control unit BU-1-60 (see Electrical Accessories). The control unit is supplied separately.

#### Mounting features

- Suitable for external or built-in mounting.
- Flexible duct application is recommended in case of remote location of the ventilation shaft. The air duct is connected to the fan exhaust flange through a clamp.
- Fixed to wall by self-tapping screws or fixing brackets.
- Suitable for ceiling mounting.

#### Aerodynamic characteristics

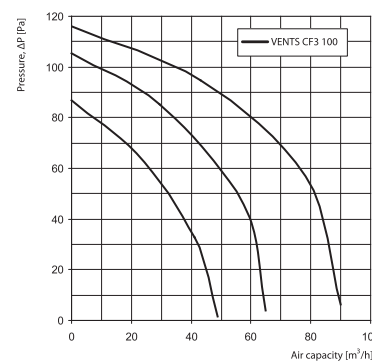

#### Overall dimensions

Model	Dimensions [mm]						
	Ø D	B	H	L	L1	L2	L3
VENTS CF3 100	100	180	195	132	59	73	26

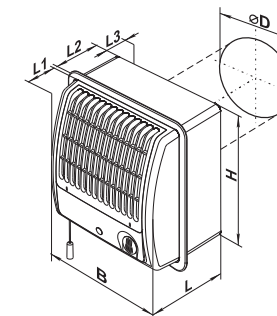

#### Technical data

Model	Frequency [Hz]	Voltage [V]	Power Consumption [W]	Current [A]	R.p.m.	Maximum air capacity [m <sup>3</sup> /h]	Sound Pressure Level at 3 m [dB(A)]	Weight [kg]
VENTS CF3 100	1 скорость	50/60	220-240	13	0,08	825	48	25
	2 скорость	50/60	220-240	17	0,11	1010	65	31
	3 скорость	50/60	220-240	27	0,16	1593	90	34

#### Mounting examples



Wall surface mounting



Wall flush mounting

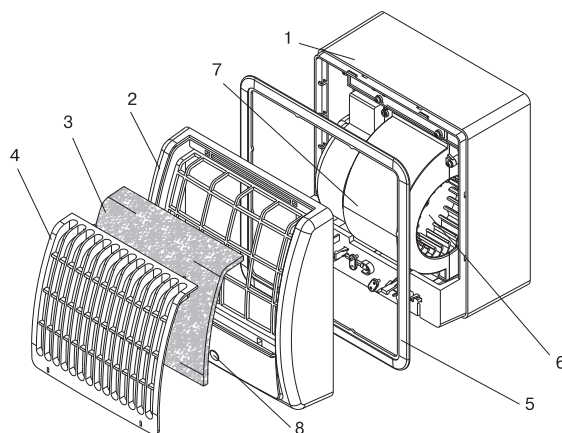

- 1. Casing
- 2. Removable cover
- 3. Filter
- 4. Grille
- 5. Decorative frame
- 6. Impeller
- 7. Scroll casing
- 8. Light indicator

#### Accessories



#### Certificates

CE, GS, ME 10, B, IP 24 The fans meet the applicable safety and electromagnetic compatibility standards.